

# DON-JO

MFG., INC.

## GO-TO SOLUTIONS FROM DON-JO

NEW  
PRODUCT  
REVIEW  
2024

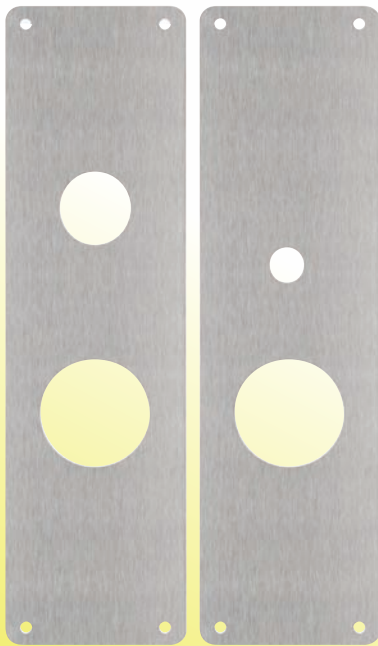

REMODELER  
PLATES



STRIKES



DOOR PIVOTS



DOOR SEAM  
FILLER PLATES



EDGE  
REINFORCERS



FRAME  
DIMPLER TOOL



UNIVERSAL DOME STYLE  
DOOR STOPS



MODERN  
WHEELCHAIR  
SIGN

# DON-JO

MFG., INC.

**NEW  
PRODUCT  
REVIEW  
2024**

## Remodeler Plates

*pre-drilled for the most popular  
mortise lock functions*

### Features

- Finishes: 605, 613, 622, 630
- Saves costly door replacement
- 22 gauge
- 4 ea. #8 x 3/4" Truss Head SMS fastener
- Remodeler Plates for repairing and reconfiguring doors

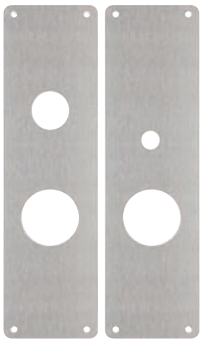

#### RP 9050

3 1/2" X 12"  
Works with  
Schlage Locks  
(Sold in Pairs)

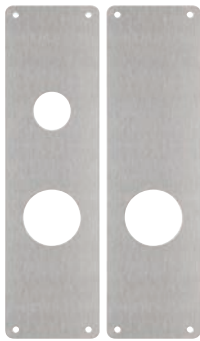

#### RP 9080

3 1/2" X 12"  
Works with  
Schlage Locks  
(Sold in Pairs)

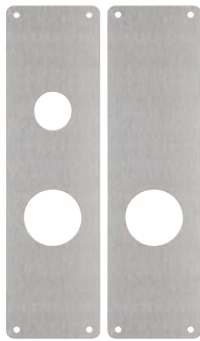

#### RP 4020

3 1/2" X 12"  
Works with  
Corbin Russwin  
and Best Locks  
(Sold in Pairs)

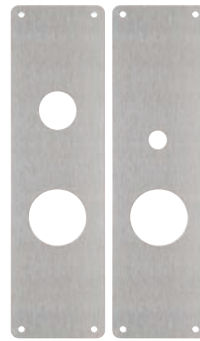

#### RP 4020T

3 1/2" X 12"  
Works with  
Corbin Russwin  
and Best Locks  
(Sold in Pairs)

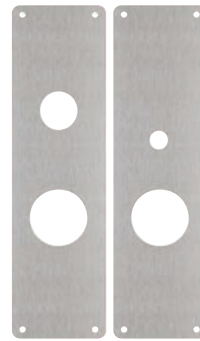

#### RP 8205

3 1/2" X 12"  
Works with  
Sargent and Yale  
Locks  
(Sold in Pairs)

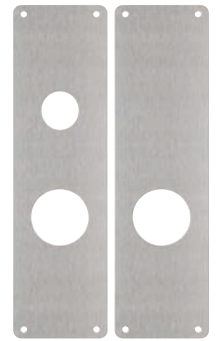

#### RP 8255

3 1/2" X 12"  
Works with  
Sargent and Yale  
Locks  
(Sold in Pairs)

## Remodeler Plates

*for use with BEST Locks*

### Features

- Finishes: 605, 613, 622, 630
- Saves costly door replacement
- 22 gauge
- 4 ea. #8 x 3/4" Truss Head SMS fastener
- Remodeler Plates for repairing and reconfiguring doors



#### RP 9K45

3 1/2" X 4 1/2"  
Works with  
BEST Locks



#### RP 9K09

3 1/2" X 9"  
Works with  
BEST Locks



#### RP 9K15

3 1/2" X 15"  
Works with  
BEST Locks



#### RP 9K14

4 1/2" X 14"  
Works with  
BEST Locks

# DON-JO

MFG., INC.

NEW  
PRODUCT  
REVIEW  
2024

## Door Seam Filler Plate

### Features & Options

- 25 Gauge Steel Construction
- Size: 4.5" x 1.605"
- Finished in gray primed paint
- Covers the edge seam of a hollow metal door with standard weight commercial grade hinges. (4.5 x 4.5)
- Shelf pack: 30
- The universal (non-handed) design provides solutions for use of new hardware on existing doors
- Great for non-handed doors

DSF 45

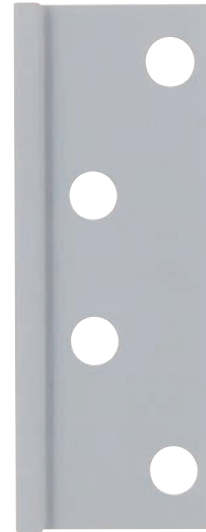

## Conversion Plate for 1-3/8" Doors

*For Mortise Locks to Cylindrical Locks*

### Features

- Converts an 86-prep cut out to a 161-prep cut out
- Finishes: PC, SL, DU, 622
- Works on 1-3/8" door
- 7/8" Latch hole
- 8" X 1"
- Saves costly door replacement

CV 138



# DON-JO

MFG., INC.

NEW  
PRODUCT  
REVIEW  
2024

## 4 7/8" Mortise Strikes



### EWSMST 161

- Size: 4-7/8" x 1-1/4"
- ANSI Curved Lip Strike with Extra Wide Double Mortise Latch Holes
- Available finishes: 622, 629, 630, DU (Dark Brown), SL (Silver Coated)



### MBFD 2

- Size: 4-7/8" x 1-1/4"
- ANSI Flat Lip Strike with Single Mortise Latch Hole
- Available finishes: 622, 629, 630, DU (Dark brown), SL (Silver Coated)



### SMBFD 2

- Size: 4-7/8" x 1-1/4"
- ANSI Flat Lip Strike with Double Mortise Latch Holes
- Available finishes: 622, 629, 630, DU (Dark brown), SL (Silver Coated)

## Standard Size Replacement Strikes

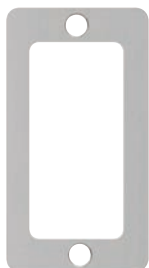

### DS 234 RC

- Size: 2-3/4" x 1-1/8"
- Deadbolt Strike with 1/4" Radius Corners
- Available finishes: 622, 629, 630, DU (Dark brown)



### SMST 161

- Size: 4-7/8" x 1-1/4"
- Standard ANSI Strike with Double Mortise Latch Holes
- Available finishes: 622, 629, 630, DU (Dark brown), SL

# DON-JO

MFG., INC.

**NEW  
PRODUCT  
REVIEW  
2024**

## ***New Finish on Extended Lip Strikes - 629***

- Available on all ANSI type strikes
- Sizes: 1-1/2", 1-5/8", 1-3/4", 2", 2-1/2", 3", and 4"
- Width measure is from center of screw hole to end of lip
- Available finishes: 622, 629, 630, DU (Dark brown)



**EST 100  
Series**



**MEST 100  
Series**



**SMEST 100  
Series**

## ***Double Hole Edge Reinforcers***

***For Use with 1-3/4" Doors***



**2358 FE**

3-5/8" CTC  
9" Height



**24 FE**

4" CTC  
9" Height



**255 FE**

5-1/2" CTC  
12" Height



**26 FE**

6" CTC  
12" Height

Available finishes: 10B, PB (Polished Brass), S (Stainless Steel), 622

# DON-JO

MFG., INC.

**NEW  
PRODUCT  
REVIEW  
2024**

## Door Pivots



**TP 34  
Top Pivot**



**IP 34  
Intermediate Pivot**



**BP 2 34  
Bottom Pivot**

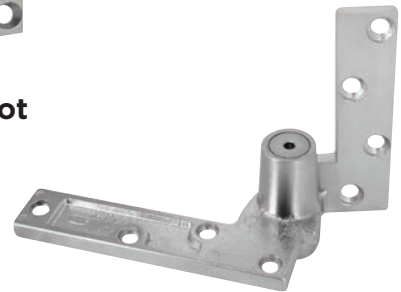

**BP 1 34  
Bottom Pivot**

### Features

- Load capacity 600 Lbs
- Available in an assortment of finishes

## Universal Dome Style Door Stop



**1454  
622 Finish**



**1454  
626 Finish**



**1454  
613 Finish**

### Features

- New Modern Design
- Low Front/High Back Door Stop
- Spring Cushioned Rubber Bumper
- Cast Zinc
- Packed with 12 x 1-1/4" Wood Screw Fastener and Plastic Anchor

Height	Diameter	Base
1-1/2"	1-3/4"	1/4"

**Finishes:** 613, 622, 626

# DON-JO

MFG., INC.

NEW  
PRODUCT  
REVIEW  
2024

## Frame Dimpler Tool

**Aids in hollow metal door frame installation!**

Typically, a frame is “punched & dimpled” three to four times on each side of the door frame. The FDT 1 makes the job an easy one with a professional looking fit to the fasteners.

### Features & Options

- Used when installing a new hollow metal frame in an existing masonry or stud opening.
- Hardened steel. Uses an Allen screw & wrench to smoothly add a dimple to the frame.
- The tool is double-sided; after extensive use simply use the opposite side.
- Can be used with an impact wrench.
- Two 3/8" x 1" Allen screws and a long-arm Allen wrench are included.
- The FDT 1 makes it easy to provide a flush appearance to the frame fasteners.



**FDT 1  
Frame  
Dimpler Tool**

## Modern Wheelchair Accessible Sign

### Features

- Sizes: 6" x 6"
- White on Blue Plastic Sign



HS 9070 39

# DON-JO

## MFG., INC.

**NEW  
PRODUCT  
REVIEW  
2024**

### Door Seam Filler Plate

DSF 45 \$2.95

### Double Hole Edge Reinforcers

2358 10B FE \$28.80  
2358 622 FE \$29.20  
2358 PB FE \$35.75  
2358 S FE \$24.20  
24 10B FE \$28.80  
24 622 FE \$29.20  
24 PB FE \$35.75  
24 S FE \$24.20  
255 10B FE \$37.20  
255 622 FE \$37.90  
255 PB FE \$43.80  
255 S FE \$30.20  
26 10B FE \$37.20  
26 622 FE \$37.90  
26 PB FE \$43.80  
26 S FE \$30.20

### Frame Dimpler Tool

FDT 1 \$240.65

### Modern Wheelchair Accessible Sign

HS 9070 39 \$21.15

### New Finish - 629

EST 102 629 \$29.15  
EST 103 629 \$29.15  
EST 104 629 \$31.05

EST 115 629 \$29.15  
EST 125 629 \$29.15  
EST 158 629 \$29.15  
EST 175 629 \$29.15  
MEST 102 629 \$31.05  
MEST 103 629 \$31.05  
MEST 104 629 \$34.60  
MEST 115 629 \$31.05  
MEST 125 629 \$31.05  
MEST 158 629 \$31.05  
MEST 175 629 \$31.05  
SMEST 102 629 \$31.05  
SMEST 103 629 \$31.05  
SMEST 104 629 \$34.60  
SMEST 115 629 \$31.05  
SMEST 125 629 \$31.05  
SMEST 158 629 \$31.05  
SMEST 175 629 \$31.05

### Door Pivots

BP 1 34 613 LHR \$326.50  
BP 1 34 613 RHR \$326.50  
BP 1 34 626 LHR \$326.50  
BP 1 34 626 RHR \$326.50  
BP 2 34 613 \$357.30  
BP 2 34 626 \$357.30  
IP 34 613 LHR \$253.45  
IP 34 613 RHR \$253.45  
IP 34 626 LHR \$253.45  
IP 34 626 RHR \$253.45  
TP 34 613 \$187.20  
TP 34 626 \$187.20

### Remodeler Plates

RP 4020 605 \$50.80  
RP 4020 613 \$71.20  
RP 4020 622 \$85.90

RP 4020 630 \$37.70  
RP 4020T 605 \$50.80  
RP 4020T 613 \$71.20  
RP 4020T 622 \$85.90  
RP 4020T 630 \$37.70  
RP 8205 605 \$50.80  
RP 8205 613 \$71.20  
RP 8205 622 \$85.90  
RP 8205 630 \$37.70  
RP 8255 605 \$50.80  
RP 8255 613 \$71.20  
RP 8255 622 \$85.90  
RP 8255 630 \$37.70  
RP 9K09 605 \$19.40  
RP 9K09 613 \$28.60  
RP 9K09 622 \$40.95  
RP 9K09 630 \$14.85  
RP 9K14 605 \$33.85  
RP 9K14 613 \$42.35  
RP 9K14 622 \$54.70  
RP 9K14 630 \$28.25  
RP 9K15 605 \$28.85  
RP 9K15 613 \$38.15  
RP 9K15 622 \$50.50  
RP 9K15 630 \$23.55  
RP 9K45 605 \$18.05  
RP 9K45 613 \$27.05  
RP 9K45 622 \$39.40  
RP 9K45 630 \$13.40  
RP 9050 605 \$50.80  
RP 9050 613 \$71.20  
RP 9050 622 \$85.90  
RP 9050 630 \$37.70  
RP 9080 605 \$50.80  
RP 9080 613 \$71.20  
RP 9080 622 \$85.90  
RP 9080 630 \$37.70

### Standard Size Replacement Strikes

DS 234 622 RC \$8.15  
DS 234 630 RC \$4.90  
DS 234 DU RC \$7.65  
SMST 161 629 \$12.80  
SMST 161 630 \$10.50  
SMST 261 DU \$9.40  
SMST 261 622 \$12.40

### Universal Dome Style Door Stop

1454 613 \$17.05  
1454 622 \$17.40  
1454 626 \$13.30

### 4-7/8" Mortise Strike Options

EWSMST 161 DU \$19.60  
EWSMST 161 SL \$19.60  
EWSMST 161 622 \$21.10  
EWSMST 161 629 \$19.80  
EWSMST 161 630 \$18.15  
MBFD 2 DU \$11.05  
MBFD 2 SL \$11.05  
MBFD 2 622 \$13.10  
MBFD 2 629 \$13.55  
MBFD 2 630 \$11.90  
SMBFD 2 DU \$11.35  
SMBFD 2 SL \$11.35  
SMBFD 2 622 \$13.40  
SMBFD 2 629 \$13.85  
SMBFD 2 630 \$12.20

Prices are accurate at date of printing.